

raqball

RB2.0



These instructions must be read before use and must be kept safely for further reference throughout the life of the product.



Assembly time: 5 minutes

Target & Board Support Module

ASSEMBLY INSTRUCTIONS

More information:

www.raqball.com



© 2025 - RZBALL COMPANY

120 Route des macarons - 06560 VALBONNE SOPHIA ANTIPOLIS - France



EN

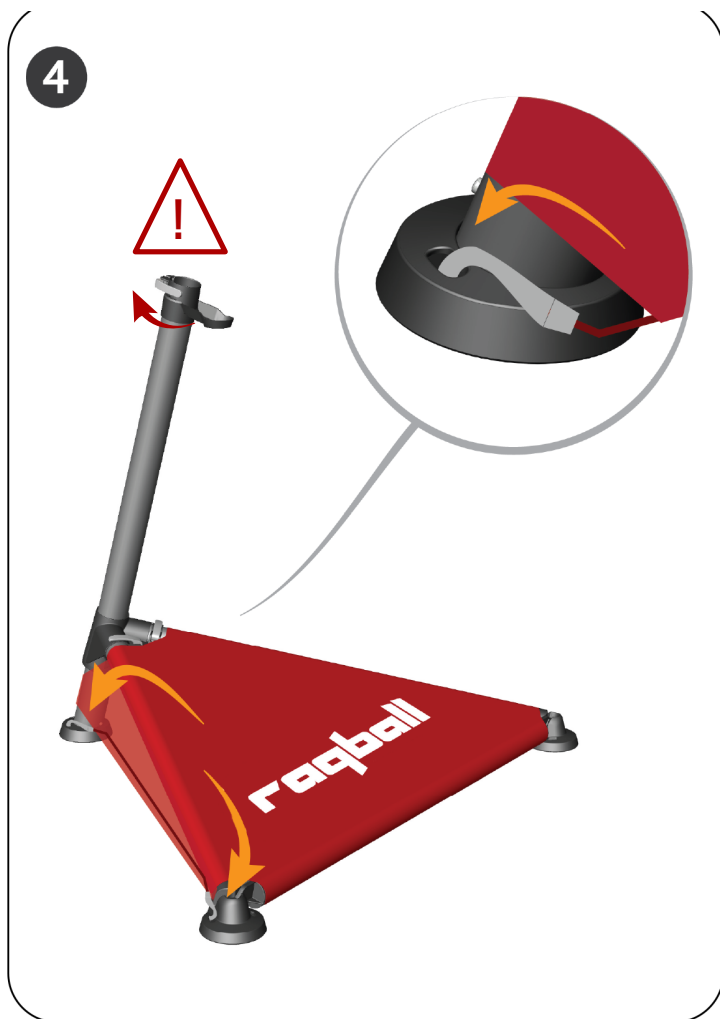
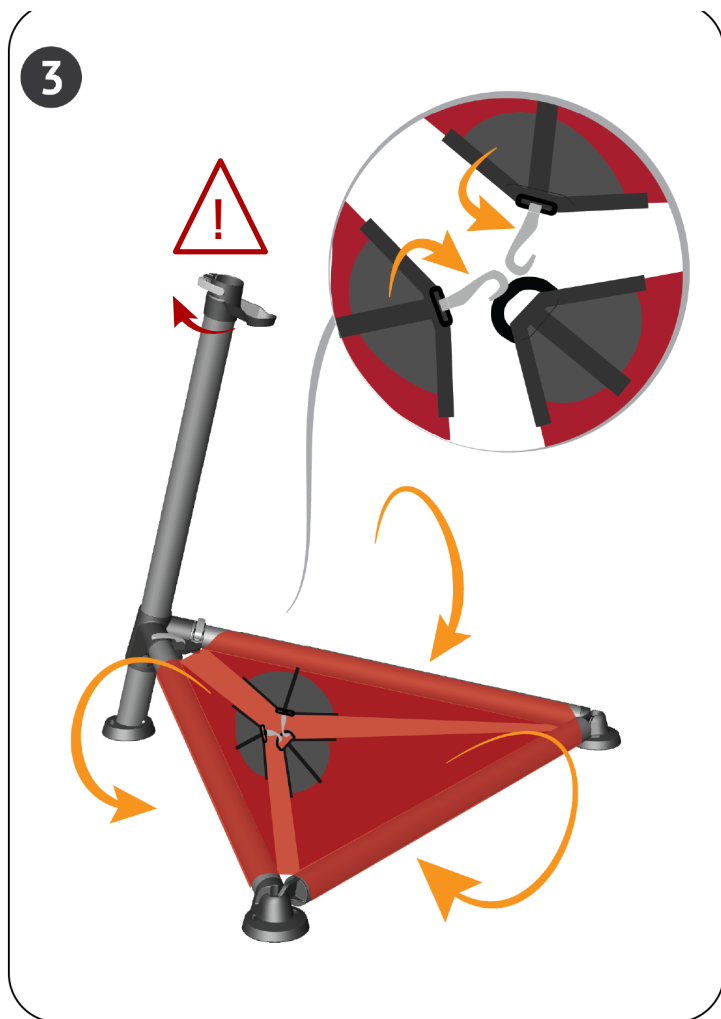
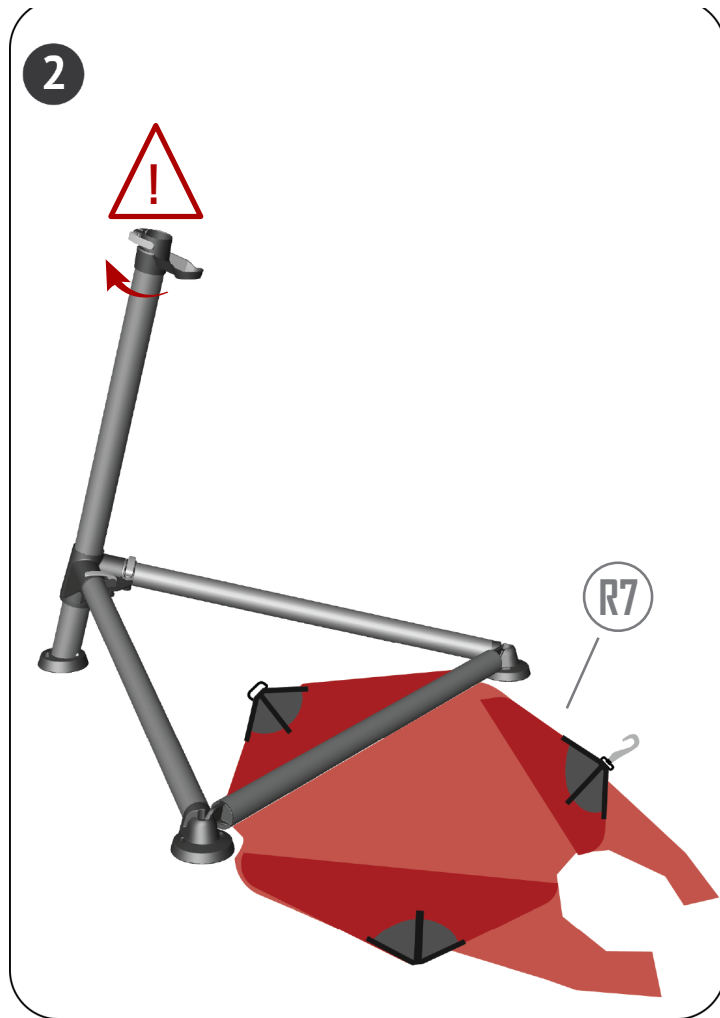
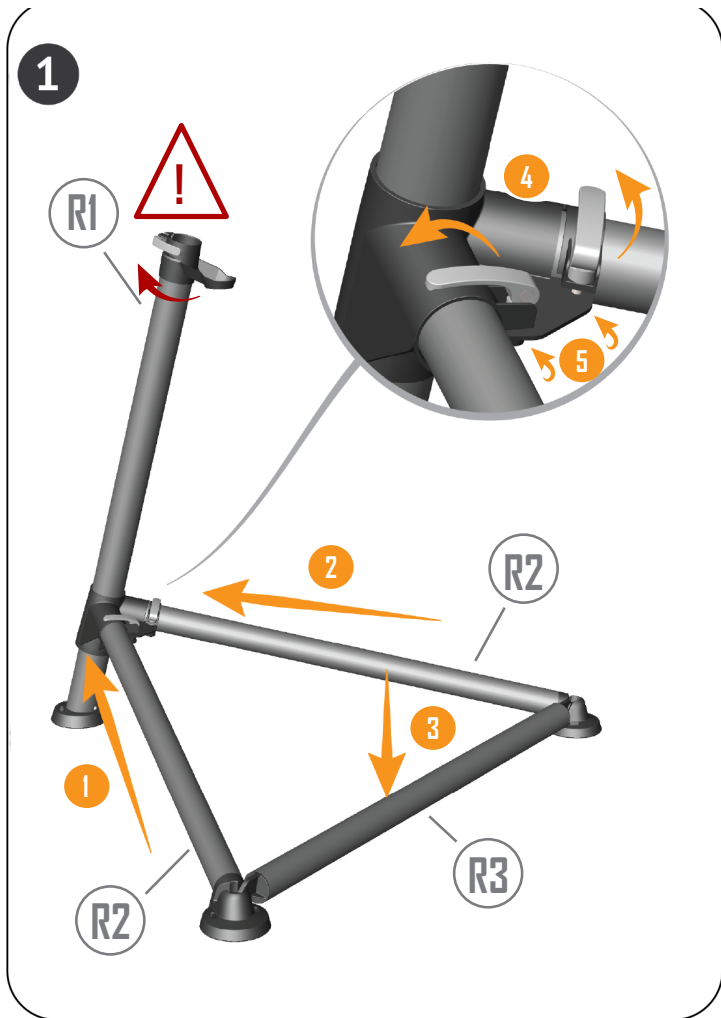

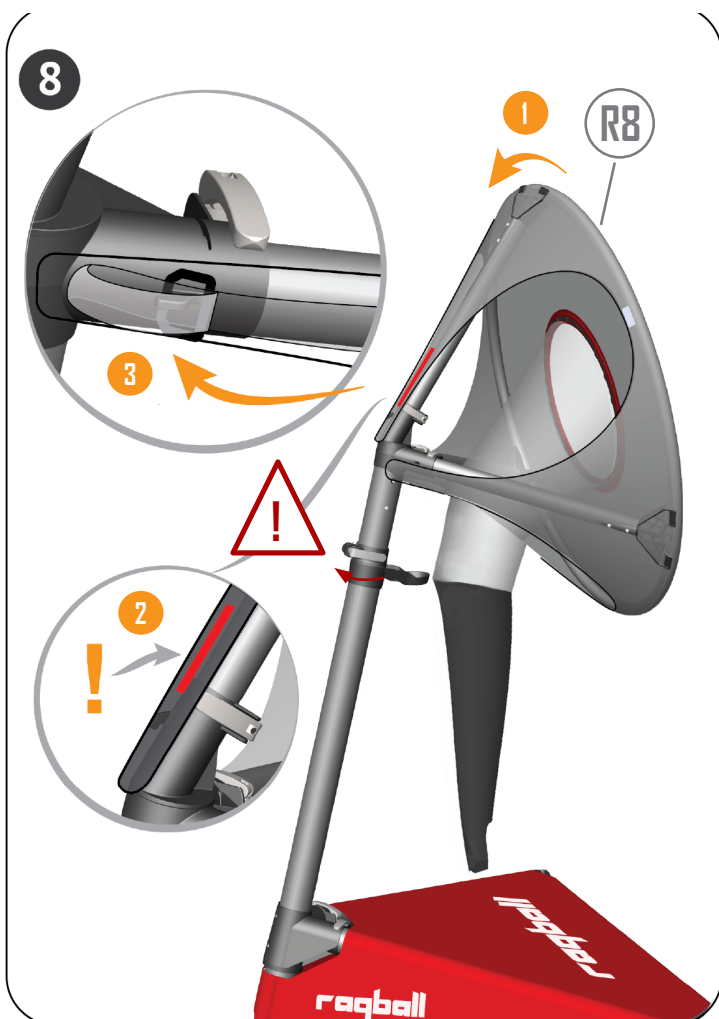
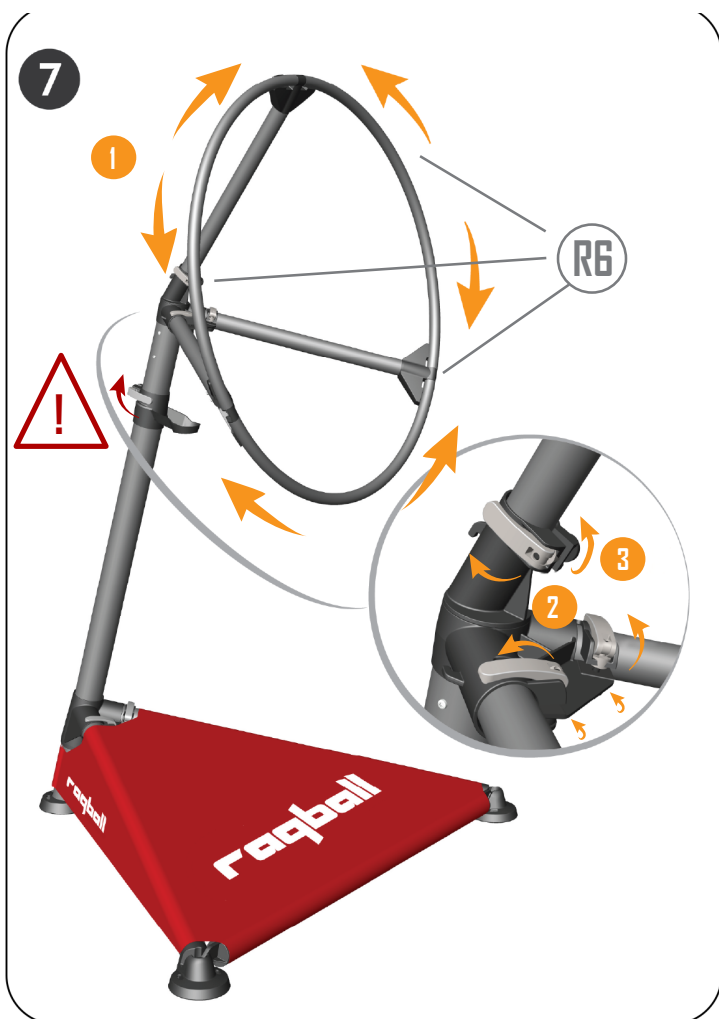
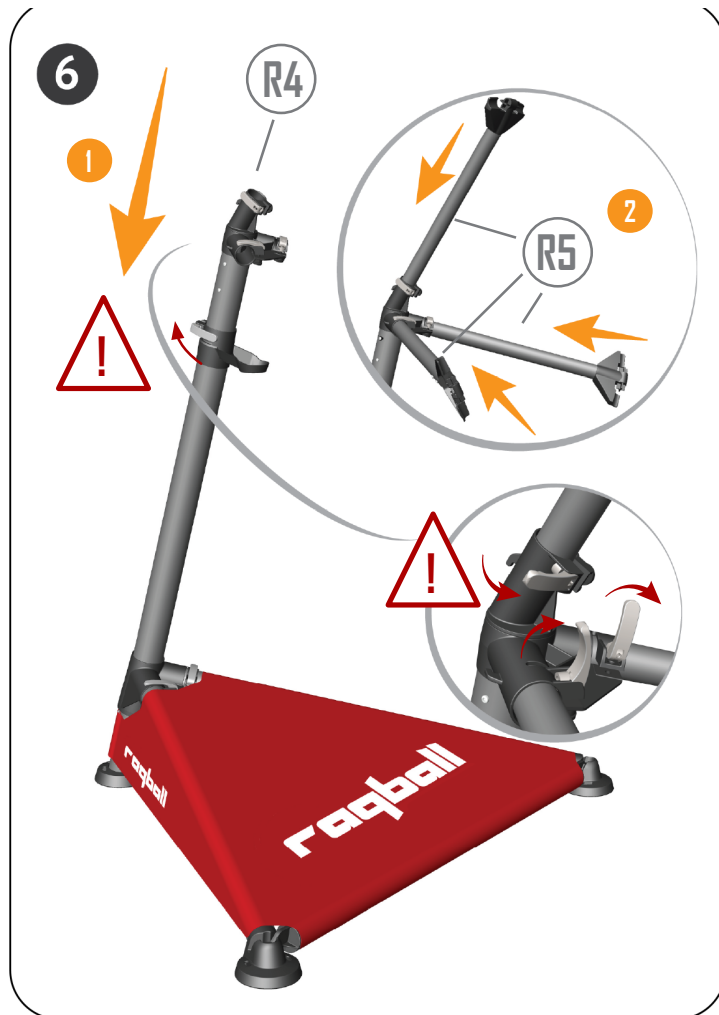

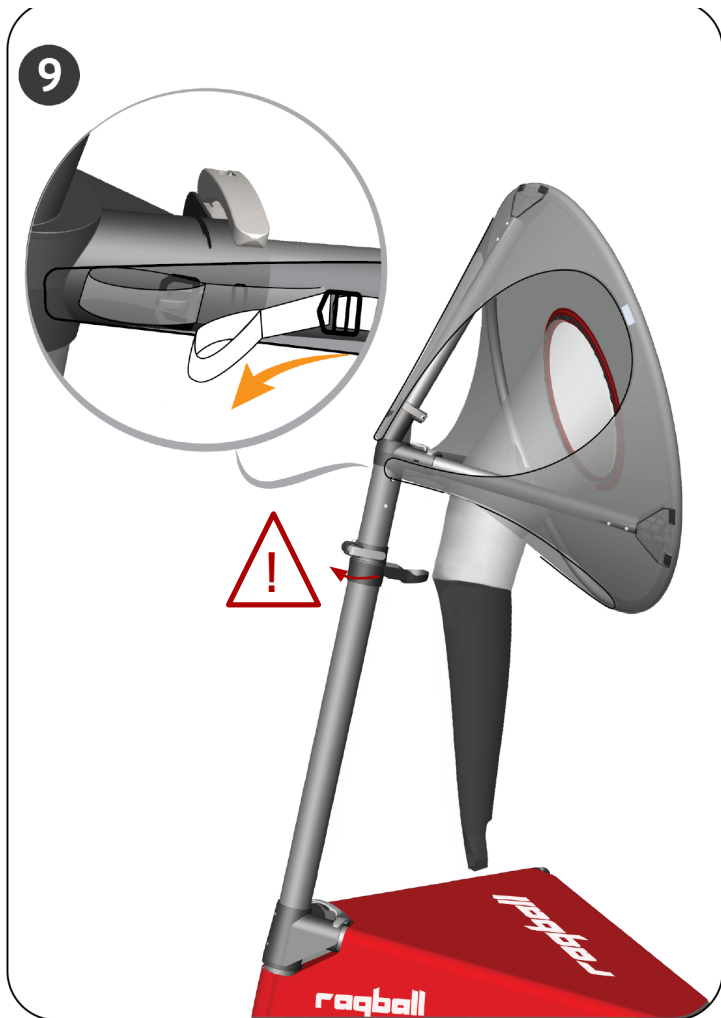

Parts in the **Raqball RB2.0** Target Board & Support Module

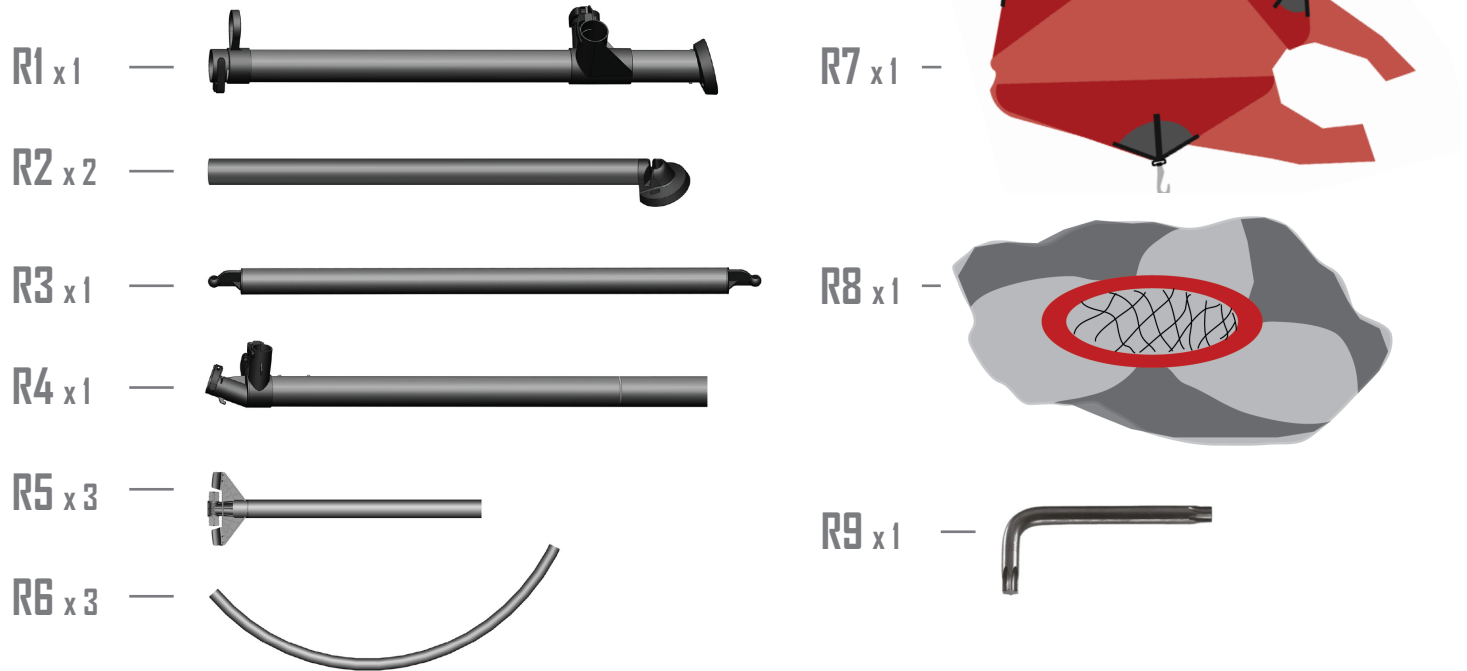

Raqball Portable Court Equipment RB2.0

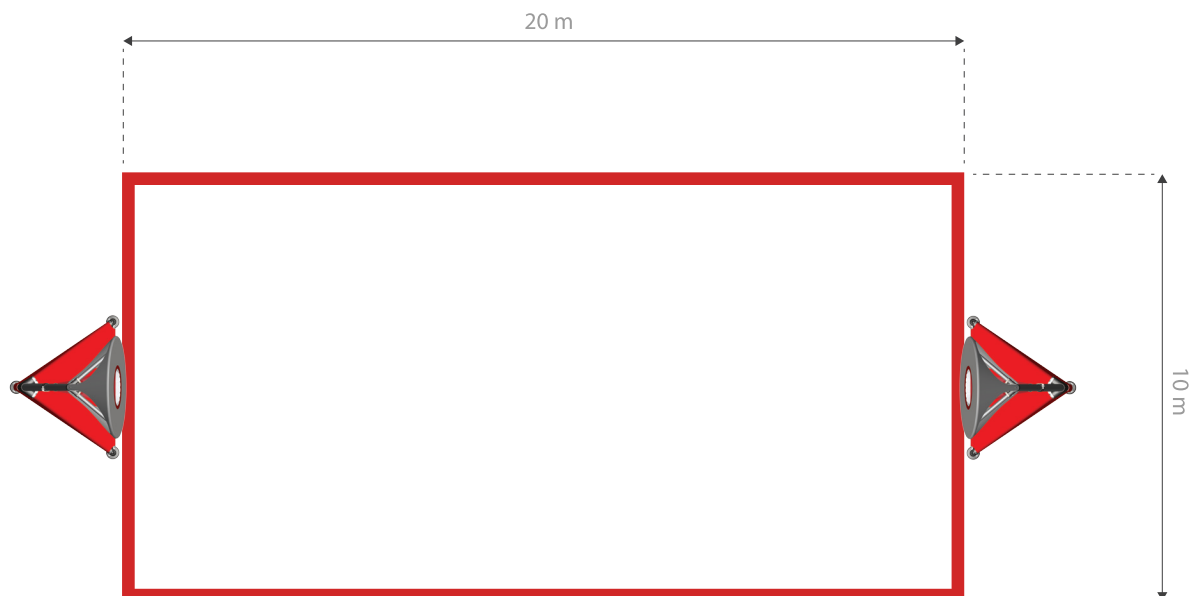

ASSEMBLY MANUAL WITH SAFETY INFORMATION AND PRECAUTIONS FOR USE

GENERAL PURPOSE WARNING:

- These instructions must be read before use and must be kept safely for further reference throughout the life of the product.
- The product is intended only for Raqball.
- Follow the assembly instructions (diagrams provided).
- Use only the parts supplied in the case for the assembly.
- Assembly must be performed by an adult.
- The equipment may only be used under the supervision of duly trained or qualified personnel.
- The equipment is not intended for family use but exclusively for professional use.
- The equipment must not be used improperly.
- Do not climb or exert undue force on the frame.
- Do not use the equipment during severe wind conditions.
- The equipment must be maintained by the owner to ensure that it complies with the appropriate safety requirements at all times.
- The owner should schedule periodic checks and maintenance of the equipment.
- The owner must keep an up-to-date log in which the dates and results of required inspections and testing are recorded.
- The owner must ensure that all players know and follow the instructions for use of the equipment.
- Any equipment that doesn't comply with safety requirements must be rendered inaccessible to users by the owner or operator.

DURING ASSEMBLY:

- Ensure that all fittings (Visually and manually check) the stability and solidity of the equipment each time the equipment is installed.
- Confirm that the knurled screws aren't overly tight, which could otherwise scratch the tubes.
- In order to avoid toppling, ensure that the assembly is mounted correctly and stands level on its feet.
- Ensure that all the fittings are properly tightened before use.
- When using the board on loose or sandy ground, anchor pegs through the feet may be used. Recommended characteristics of the pegs: Length: 230 mm - ø: 6 mm - Sharp tip - Galvanized steel [not supplied].

IN-GAME USAGE WARNING:

- The Raqball game must be supervised under the supervision of duly trained or qualified personnel.
- Contact between players isn't permitted in this sport. A 1-meter distance between players is required*.
- Player-board contact isn't permitted and is considered to be a foul. A distance between players and the board equal to 1 meter is required*.
- Do not climb, jump on or play on the base cover or frame.
- The equipment must be lowered (part R4) during phases when no play is taking place (e.g., during pauses or between matches).

DISASSEMBLY AND STORAGE:

- Store the equipment in the case after use and then close the case.
- To prevent scratches or damage to the tubes, be sure that the knurled screws aren't excessively tight.
- Do not sit on the case or equipment when it's compacted.
- Equipment should be stored on a firm, level surface.

MAINTENANCE AND WARRANTY:

Weather conditions, corrosion or misuse can damage the system. In order to extend the operating life of your equipment, we recommend that you:

- Respect the use and the storage procedures.
- Check each component (support module, board, target tube, base, etc.) regularly to ensure that the equipment remains in good working order.
- Regularly check the fasteners for proper tightness.
- The parts that are worn must be replaced with original replacement parts from the manufacturer (no home-made repair is permitted).
- A tool is available to tighten the fittings.
- Do not use detergents to clean the equipment.
- Clean with clear, soapy water.

SAFETY INSTRUCTIONS:

FAILURE TO COMPLY WITH THESE SAFETY INSTRUCTIONS RELIEVES THE MANUFACTURER AND THE DISTRIBUTOR FROM ALL LIABILITIES AND MAY VOID THE WARRANTY.

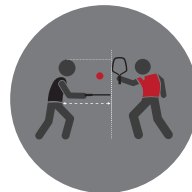

* See the rules of the game